

SAN MATEO COUNTY
COMMUNITY
COLLEGE DISTRICT

FACILITIES PLANNING,
MAINTENANCE & OPERATIONS

Capital Improvement Program Phase 3(CIP3)

DECEMBER 5, 2016

SKYLINE COLLEGE CIP3 UPDATE FORUM



Agenda

- CIP3 Planning Efforts
- Program Budget Overview
- Program Overview
 - Skyline College Building 1N
 - Skyline College Building 12N
 - Skyline Parking Lot L
 - Pacific Heights (B19)
- Tentative Schedule and Logistics
- Q & A

CIP3 Planning Efforts

- Scheduling Consultant – Contract Awarded to AECOM (April 2015)
- Cost Estimating Consultant – Contract Awarded to Leland Saylor Associates (April 2015)
- California Environmental Quality Act (CEQA) – Completed (Winter 2015)
- Construction Management (PM/CM) – Contract Awarded to Swinerton (March 2015)
- Design Standards Revision – Completed (June 2015)
- Swing Space Planning (ONUMA) – In Progress
- Architect and Engineer (A&E) Selection for Design of First Wave Projects – Completed (April 2015)
- Design Build Entity Selection (CAN B1N, SKY B12N) – Complete
- Design Build Entity Selection (CAN B23N, SKY B1N) – In Progress
- 2017 Annual General Contractor and Major Subcontractor Prequalification Process – In Progress
- Project Labor Stabilization Agreement – Amendment Approved by BOT (March 2016), Execution in Process

Project Budget Overview



Skyline College

Project	Recommended Project Budget
Social Science and Creative Arts (B1N)	\$160,000,000
Workforce and Economic Development Prosperity Center (FPP) (B2)	\$13,200,000
Library/Learning Resource (B5)	\$9,000,000
Environmental Science (B12N)	\$28,700,000
Early Childhood Education (B14)	\$1,500,000
Pac Heights (B19) & North Campus Improvements	\$10,000,000
Lot L Expansion	\$5,000,000
Total:	\$227,400,000

Project Program Overview



Skyline College Social Science and Creative Arts Building (B1)

- Budget \$160,000,000
 - Measure H
- Project Scope
 - Demolition of (E) Social Science and Creative Arts Building (B1) 72,853 GSF (79,453 – 6,600)
 - Retain and protect 6,600 GSF of Level One during demolition and construction
 - Construct new ~115,000 and renovate ~6,000 GSF Social Science and Creative Arts Building (B1)
 - Elements of the program: 520 Seat New Theater w/Orchestra Pit, Scene Shop, Gallery, Music Choral Room/Recital Hall, Concert Band Room, Labs (Piano and MDI), Recording Rooms, Sculpture, Digital Arts, Art History, 2D Design, Photography, Social Sciences, Quad (Plaza) Extension
- Status
 - DBE shortlist receiving RFP today December 5, 2016
 - Proposals due February 2017
 - Award April 2017
- Tentative Schedule
 - Target Occupancy Q1 2021

Skyline College Social Science and Creative Arts Building (B1)



Skyline College Environmental Studies Building (B12N)

- Budget \$28,700,000
 - Measure H
- Project Scope
 - Construct a new 21,000 GSF Environmental Studies Building (B12N)
 - Elements of the program: (2) Flexible (Flat) 60 seat/each Classrooms, (2) Lecture (Tiered) 128 seat/each Classrooms, Event Space for 250 Occupants, Catering Kitchen, Entrance Lobby, Offices, Outdoor Lab, Connecting Corridor to Main Campus, Optimal Building Location (Panoramic View of Pacific Ocean)
- Status
 - Contract awarded to design-build entity of XL Construction / DES Architects + Engineers
- Tentative Schedule
 - Target occupancy Q1 2019

Skyline College Environmental Studies Building (B12N)



Skyline College Environmental Studies Building (B12N)

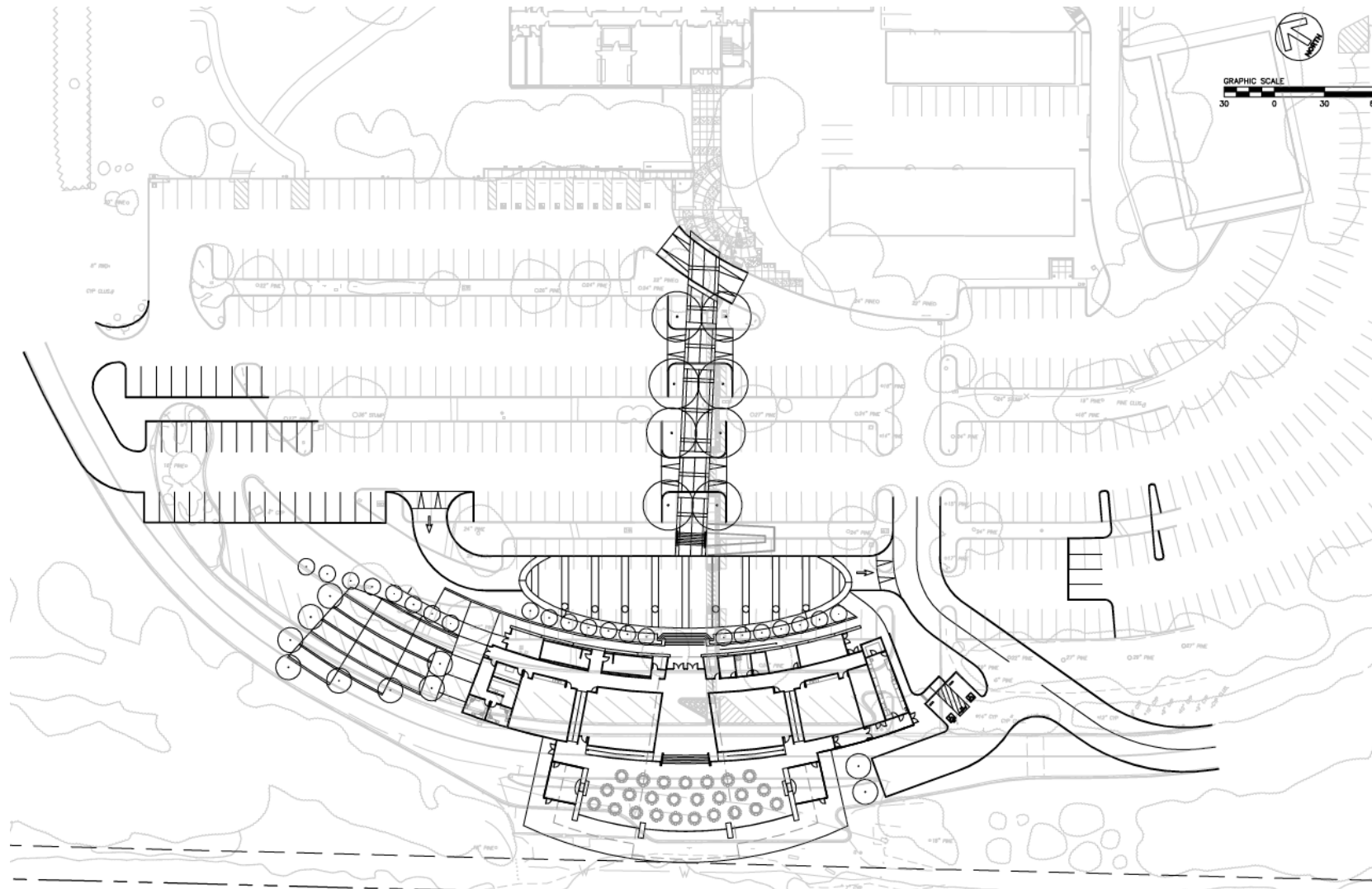

Skyline College Environmental Studies Building (B12N)

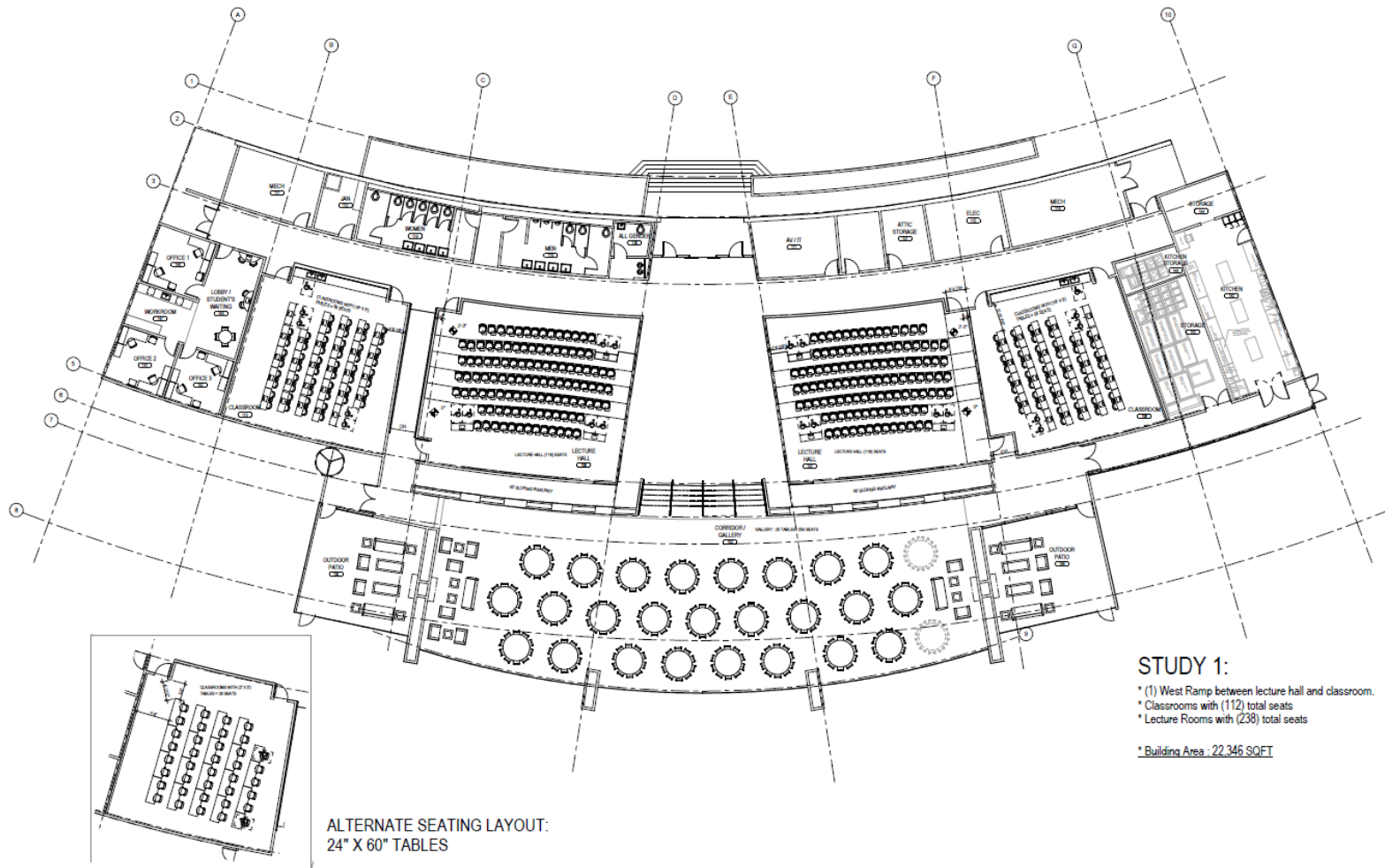

Skyline College Environmental Studies Building (B12N)



Skyline College Lot L Expansion

- Budget \$5,000,000
 - Measure H
- Project Scope
 - Expand Parking Lot L
 - Current total parking spaces: 2,494
 - At Lot L completion: 2,690
 - During B1 & B2 construction: 2,505
 - At completion of B1 & B2: 2,523
- Status
 - In DSA for review
 - Will go to bid in Spring 2017
- Tentative Schedule
 - Complete before B12 and B1 construction
 - Target occupancy Q4 2017

Skyline College Lot L Expansion



USER GROUP MEETING 10

LOT L EXPANSION, SKYLINE COLLEGE
SAN BRUNO, CALIFORNIA

GRAPHIC SITE PLAN



SEPTEMBER 7, 2016 - REVISED

Skyline College Pacific Heights (B19) Swing Space

- Budget \$ TBD
 - Measure H
- Project Scope
 - Prepare B19 to receive B1 occupants
 - Art, music, drama will swing to San Bruno Union High School facilities
- Status
 - In design
- Tentative Schedule
 - Complete before B1 construction
 - Target occupancy Q2 2018

Skyline College Pacific Heights (B19) Swing Space

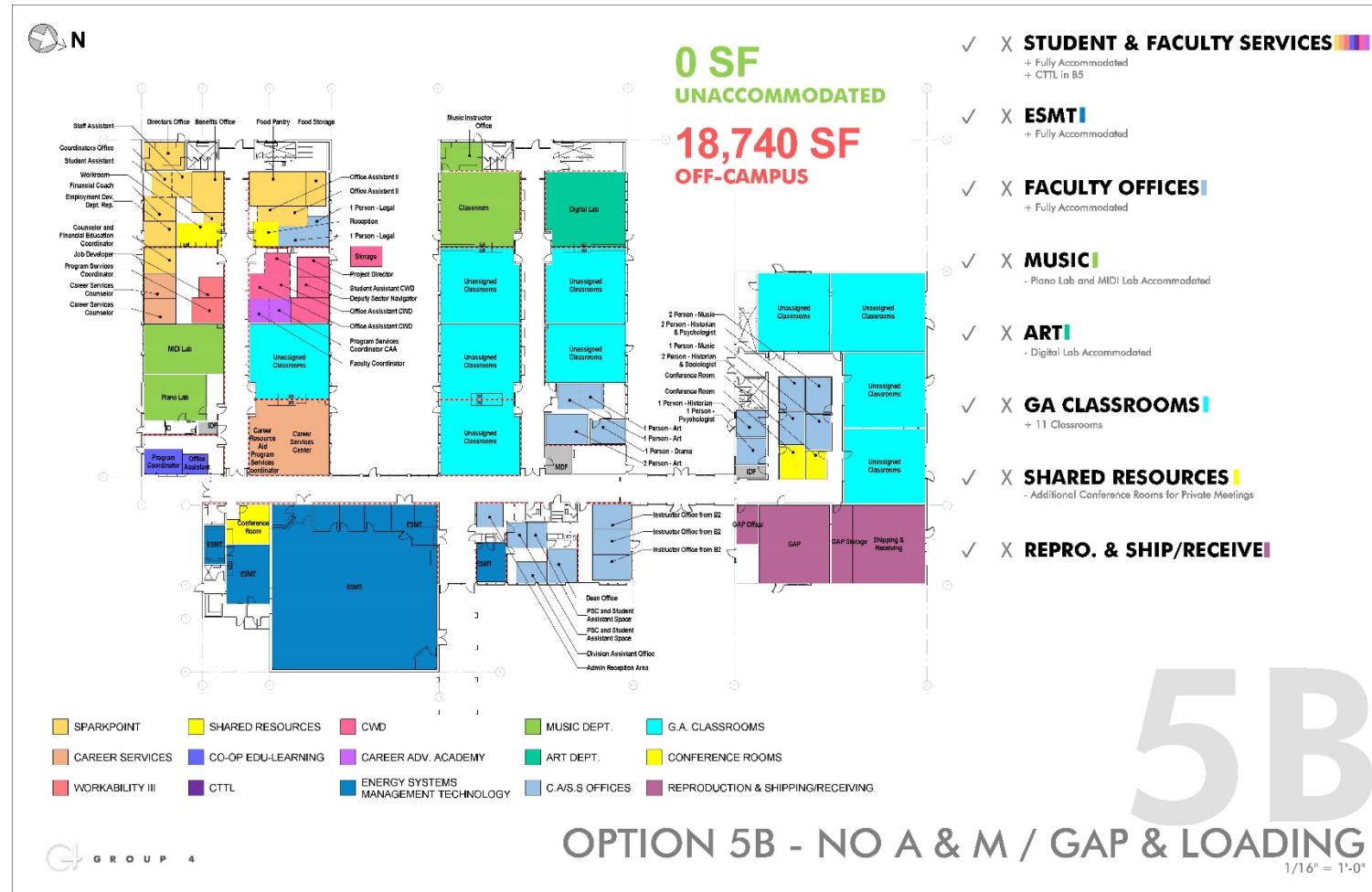

Skyline College Tentative Schedule*

	2016					2017					2018					2019					2020					2021					2022					2023																																						
	A	M	J	J	A	S	O	N	D	J	F	M	A	M	J	J	A	S	O	N	D	J	F	M	A	M	J	J	A	S	O	N	D	J	F	M	A	M	J	J	A	S	O	N	D	J	F	M	A	M	J	J	A	S	O	N	D	J	F	M	A	M	J	J	A	S	O	N	D	J	F	M	A	M
SKY Lot L Expansion	Design & DSA					Bid					Construction																																																															
SKY B12	RFSOQ/P					Design & DSA					Construction																																																															
SKY B19 Pac Hts	Design & DSA - Swing Space					Bid					Construction										Design & DSA - Modernization					Bid					Construction																																											
SKY B1	RFSOQ/P					Design & DSA					Construction																																																															
SKY B14 Loma Chica	Design & DSA					Bid					Construction																																																															
SKY B2**						Design & DSA					Bid					Construction																																																										
SKY B5						Design & DSA					Bid					Construction																																																										

* Schedule is subject to change due to agency requirements, unforeseen conditions, and/or design build contractor input

** Subject to identifying swing space

Logistics

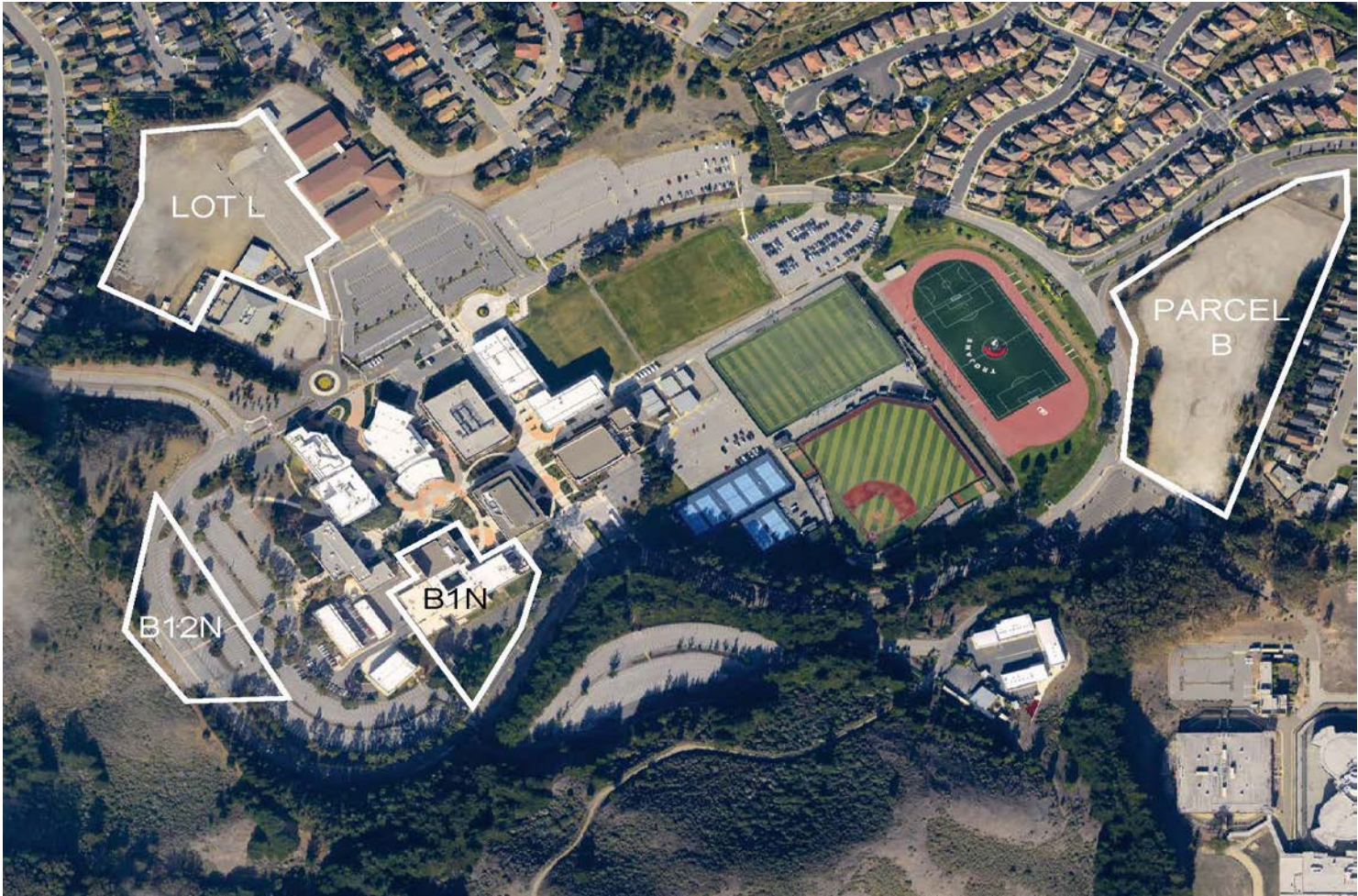

User Group Members – Thank You!

- **SKY B1 Programming User Group:**

- Eloisa Briones
- Sarah Perkins (retired)
- Donna Bestock
- Paul Bridenbaugh
- Michelle Hawkins
- Zachary Bruno
- Joshua Harris
- Bridget Fischer
- Arthur Takayama
- Amir Esfahani
- Jesse Raskin
- Mustafa Popal
- Steve Aurilio
- Jennifer Merrill
- Tiffany Schmierer

- **SKY B12 Programming User Group:**

- Tom Bauer
- Eloisa Briones
- Aaron McVean
- Ray Hernandez
- Carina Anttila-Suarez
- Carla Grandy
- John Doctor

- **SKY B19 Swing Space Programming User Group:**

- Eloisa Briones
- Aaron McVean
- Angelica Garcia
- Donna Bestock
- Luis Escobar
- Ray Hernandez
- James Houpis
- Kevin Chak
- Amanda Bortoli
- Manny Tablan
- John Doctor

- **Lot L Expansion**

- Eloisa Briones
- Sarah Perkins (retired)
- Aaron McVean
- Christine Roumbanis
- Kathryn Browne
- John Doctor
- Jim Vangele
- Tina Watts
- Robert Murphy
- Officer Sherry Campbell,
 - City of San Bruno Police Department

- **SKY B14 Programming User Group:**

- Eloisa Briones
- Christine Roumbanis
- Tina Watts
- Michelle Amaral
- Nataliya Gamburg
- Alexa Valles
- John Doctor

Questions and Answers



Cañada College • College of San Mateo • Skyline College